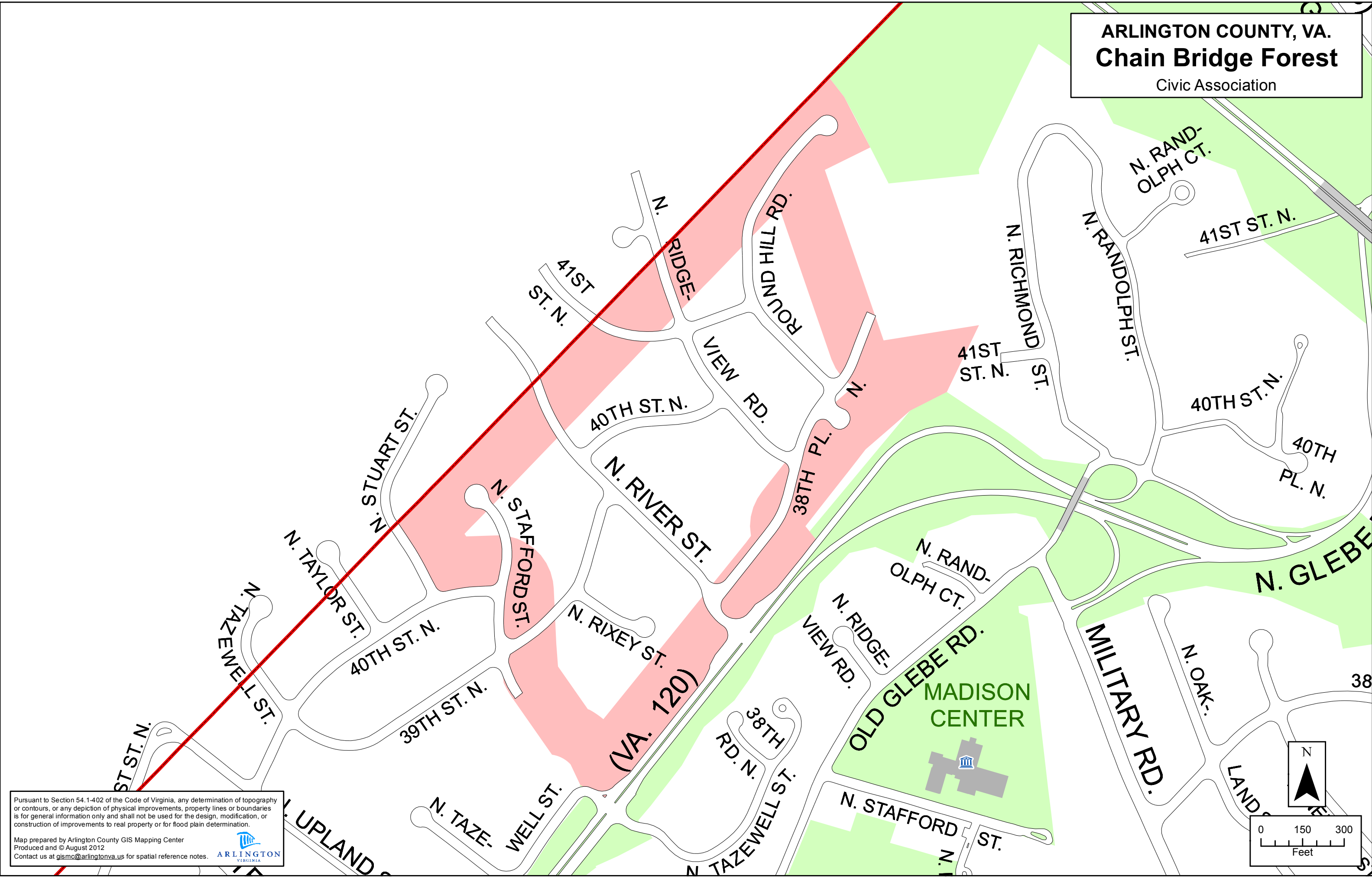
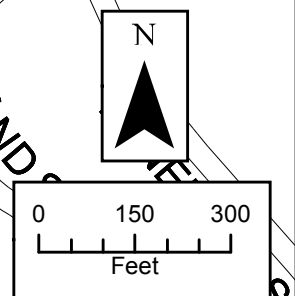

**ARLINGTON COUNTY, VA.**  
**Chain Bridge Forest**  
 Civic Association

Pursuant to Section 54.1-402 of the Code of Virginia, any determination of topography or contours, or any depiction of physical improvements, property lines or boundaries is for general information only and shall not be used for the design, modification, or construction of improvements to real property or for flood plain determination.

Map prepared by Arlington County GIS Mapping Center  
 Produced and © August 2012  
 Contact us at [gismc@arlingtonva.us](mailto:gismc@arlingtonva.us) for spatial reference notes.

ST ST. N.  
 N. TAZEWELL ST.  
 N. UPLAND ST.  
 N. TAYLOR ST.  
 N. STUART ST.  
 41ST ST. N.  
 40TH ST. N.  
 39TH ST. N.  
 40TH ST. N.  
 N. STAFFORD ST.  
 N. RIVER ST.  
 N. RIXEY ST.  
 (VA. 120)  
 38TH RD. N.  
 N. TAZEWELL ST.  
 N. WELLS ST.  
 N. RIDGE-  
 ROUND HILL RD.  
 VIEW RD.  
 38TH PL. N.  
 N. RANDOLPH ST.  
 41ST ST. N.  
 N. RICHMOND ST.  
 N. RANDOLPH CT.  
 N. RANDOLPH ST.  
 41ST ST. N.  
 40TH ST. N.  
 40TH PL. N.  
 N. GLEBE RD.  
 N. RANDOLPH CT.  
 N. RIDGE-  
 VIEW RD.  
 MADISON CENTER  
 OLD GLEBE RD.  
 MILITARY RD.  
 N. OAK--  
 LAND ST.